



How to build your robot

[www.piib.rocks/build](http://www.piib.rocks/build)



assembly instructions for:

**UPPER BODY**

*with head*



You  
Print  
Build  
Develop

*your own robot!*

## Printable parts



In order to assemble pib's upper body with the head you need to have completed all the shown tutorials.

You can find all our tutorials on [pib.rocks/build](https://pib.rocks/build)

[Tutorials on pib.rocks](https://pib.rocks/build)

[https://pib.rocks/build/how-to-build-pibs-\*\*shoulder-joint\*\*/](https://pib.rocks/build/how-to-build-pibs-shoulder-joint/)

[https://pib.rocks/build/how-to-build-pibs-\*\*upper-body\*\*/](https://pib.rocks/build/how-to-build-pibs-upper-body/)

[https://pib.rocks/build/how-to-build-pibs-\*\*neck-variant-pro\*\*/](https://pib.rocks/build/how-to-build-pibs-neck-variant-pro/)

[https://pib.rocks/build/how-to-build-pibs-\*\*head\*\*/](https://pib.rocks/build/how-to-build-pibs-head/)

## Non-printable parts



You will also need the following non-printable parts from our pib.Box Master.

If you do not have it yet, you can buy in our shop

<https://shop.pib.rocks>.

### Non-printable parts

14 x **S01** M3 nuts

6 x **S06** M3 16 mm screws

10 x **S08** M3 20 mm screws

## Step 1



Place 14 x nuts in shown spots in B01 and B02 of the shoulder joint.

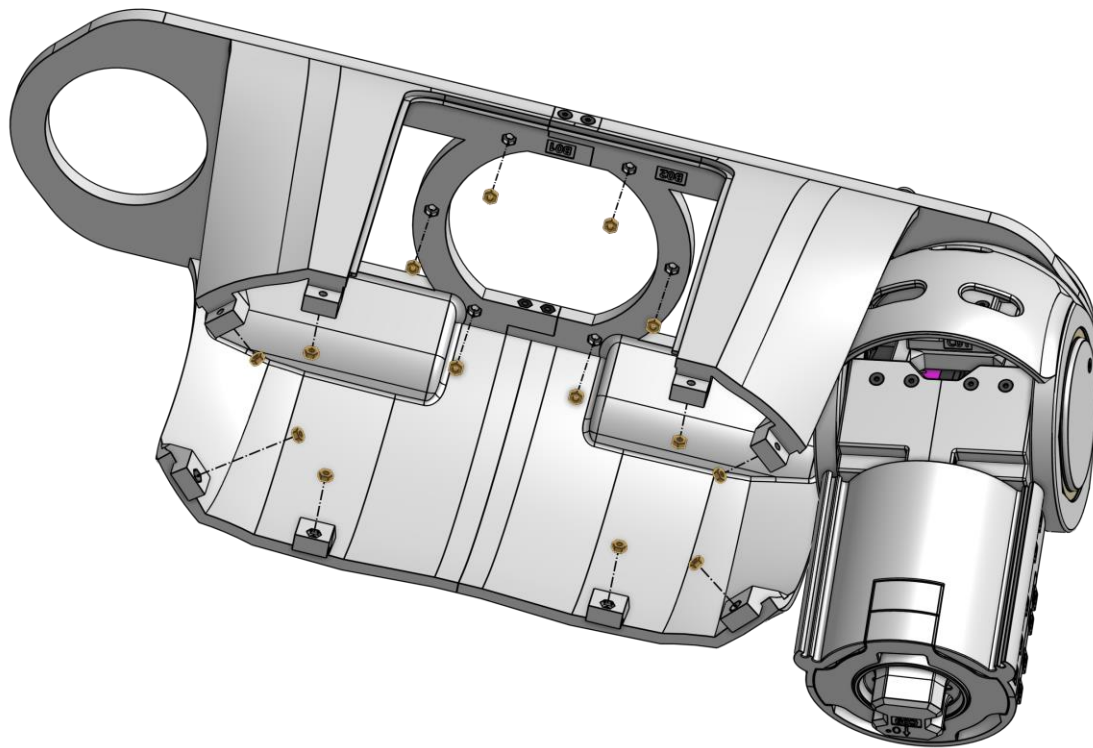

## Step 2



Connect the shoulder joint to ribcage assembly using 10 x 20mm screws.



## Step 3



Use 6 x 16mm screws to connect head and neck assembly to upperbody assembly.

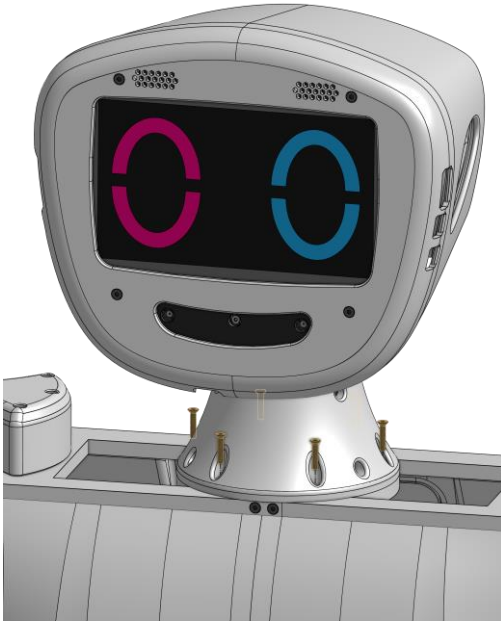

## Congratulations



You did a great job, pib's upperbody is assembled!

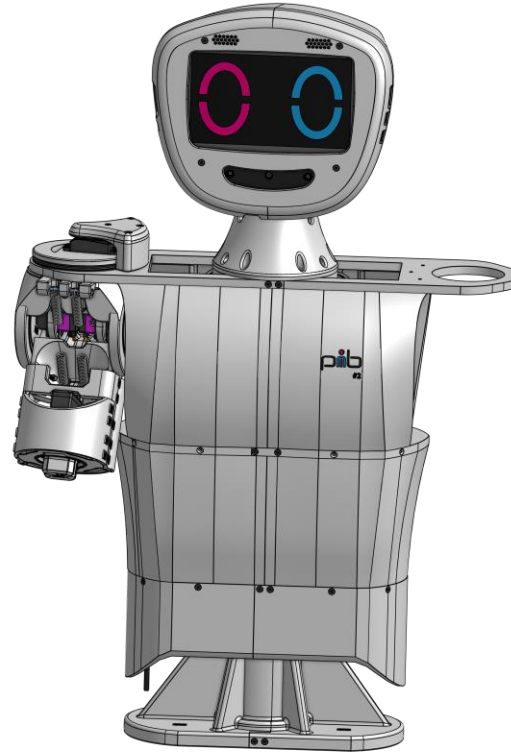

## Do you need support?



Or do you need our pib.Box with all non-printable parts?

Or maybe you have some new ideas and improvements?

Please contact us.



**team@pib.rocks**  
Send us an email.



**discord.com/invite/GRdpyeDu7P**  
Join us on Discord.



**shop.pib.rocks**  
Order non-printable parts for pib.